

S.S. Insert Adapter w Locking Rod

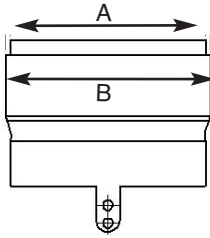

DIAMETER	CODE	A	B
3"	START03	2.875"	3.375"
4"	START04	3.875"	4.375"
5"	START05N	4.875"	5.375"
5.5"	START05.5N	5.375"	5.875"
6" DD	START06N	5.625"	6.125"
6" REG	START06RN	5.875"	6.375"
7"	START07	6.875"	7.375"
8"	START08	7.875"	8.375"

Use to connect the flex to an insert.

Simply insert locking rod to hold adapter in place.

Available in 316 SS on request.

Available on 5"-5.5"-6"DD-6"REG diameters only.

Standard StoveStarter / Insert adaptor for other diameters.